

AUTORIZACE

ČÍSLO PŘE

ČÍSLO ZMĚNY	DATUM ZMĚNY	POPIS/OBSAH ZMĚNY	PODPIS

Zlepšení dostupnosti turistických atraktivit oblasti masivu Sněžníka, aktivita „Modernizace silnice II/311 Mladkov - Jablonné n. Orlicí“

název akce

C. STAVEBNÍ ČÁST

stavební objekt

Pardubický kraj Komenského náměstí 125 532 11 Pardubice objednatel	spolupráce
úsek silnice II/311 místo stavby	Pardubický kraj



DOPRAVNĚ INŽENÝRSKÁ KANCELÁŘ
 Bozděchova 1668, 500 02 Hradec Králové
 tel : 495 219 036, 495 212 647, fax : 495 221 677
 e-mail : dik@dik - hk.cz, http : www.dik-hk.cz

PŘÍČNÉ ŘEZY výkres	1:100 měřítko	PDPS stupeň
------------------------------	------------------	----------------

ING. M. BURIANEC kontroloval	<i>Burianec</i>	ING. PAVEL ŘEHÁK hlavní inženýr projektu	<i>Řehák</i>	A014/19 číslo zakázky	C.1.7.4 číslo přílohy
ING. PAVEL ŘEHÁK zodpovědný projektant	<i>Řehák</i>	Ing. Jiří Eliášek zpracoval	<i>Elišek</i>	3/2019 datum	

1. PŘÍČNÉ ŘEZY ÚSEKY NOVÁ KONSTRUKCE VOZOVKY

190320 po 20 pric Mladkov SO 101 mc10 zac

190320 po 20 pric 45_5 zastavky Celne mc10 zac

190320 po 20 pric 45_9 vjezdova brana Celne mc10 zac

190321 po 20 pric 46_800 - 47_040 Techonin most a u podjezdu mc10 zac

2. PŘÍČNÉ ŘEZY ÚSEKY OBNOVA ŽIVIČNÉHO KRYTU VOZOVKY SO 102, SO 103, SO 104

190321 po 100 pric mc10 zac 13xA4

3. PŘÍČNÉ ŘEZY SERPENTINY SO 106 KM 49,300-49,680 NOVÁ KONSTRUKCE VOZOVKY

190321 po 20 pric mcS0 serp dva tereny 11xA3

4. PŘÍČNÉ ŘEZY ÚSEKY OBNOVA ŽIVIČNÉHO KRYTU VOZOVKY SO 105, SO 107

190408 po 100 pric mc20 konec 14xA4

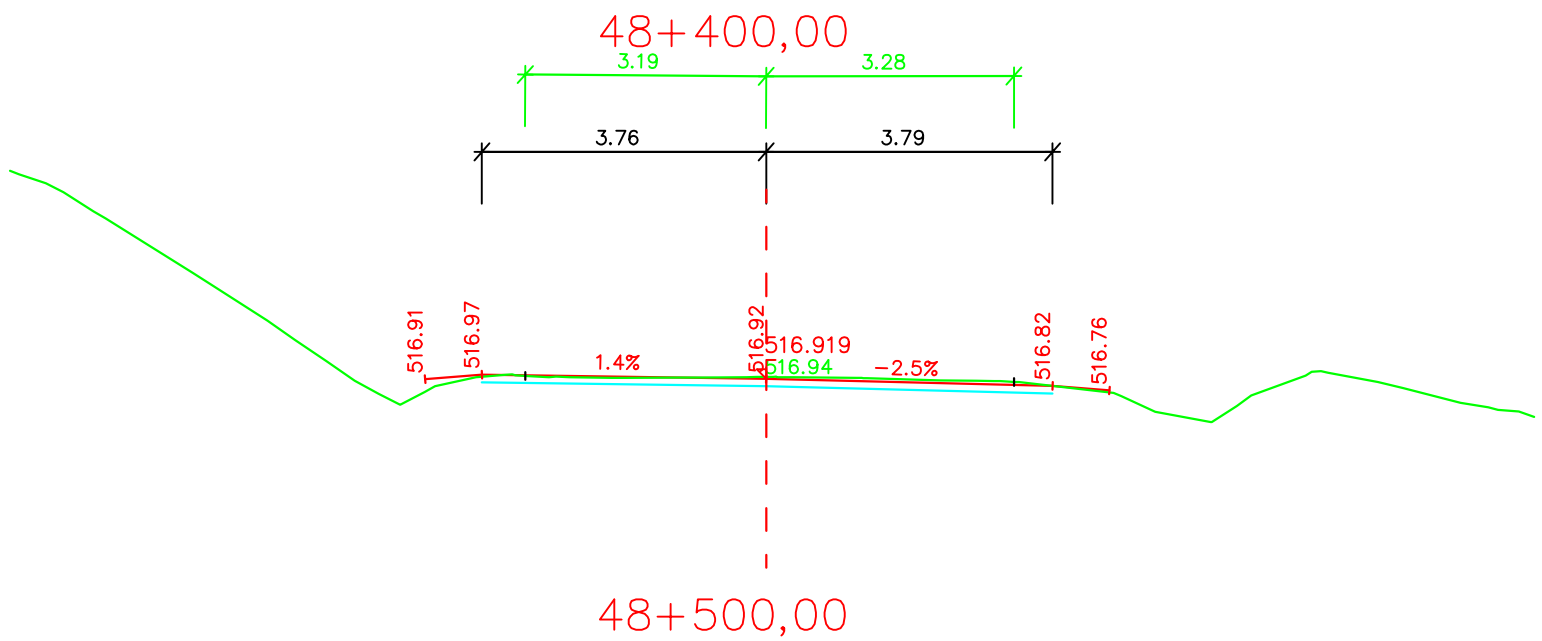

Srov.rovina= 511.0 m

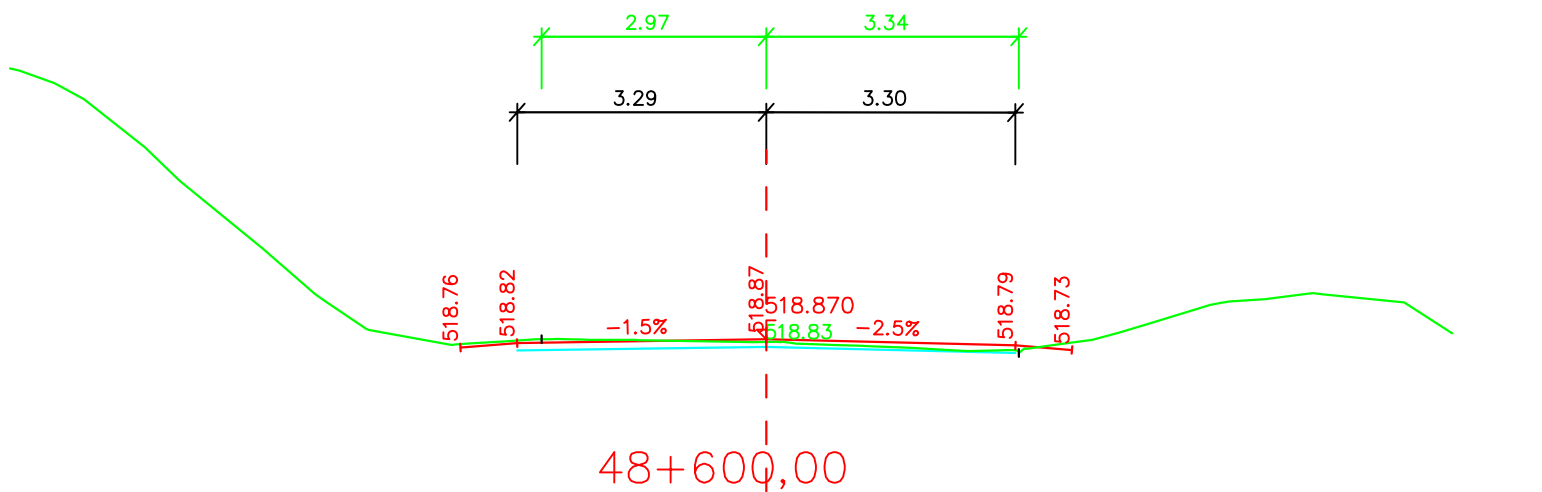

Srov.rovina= 516.0 m

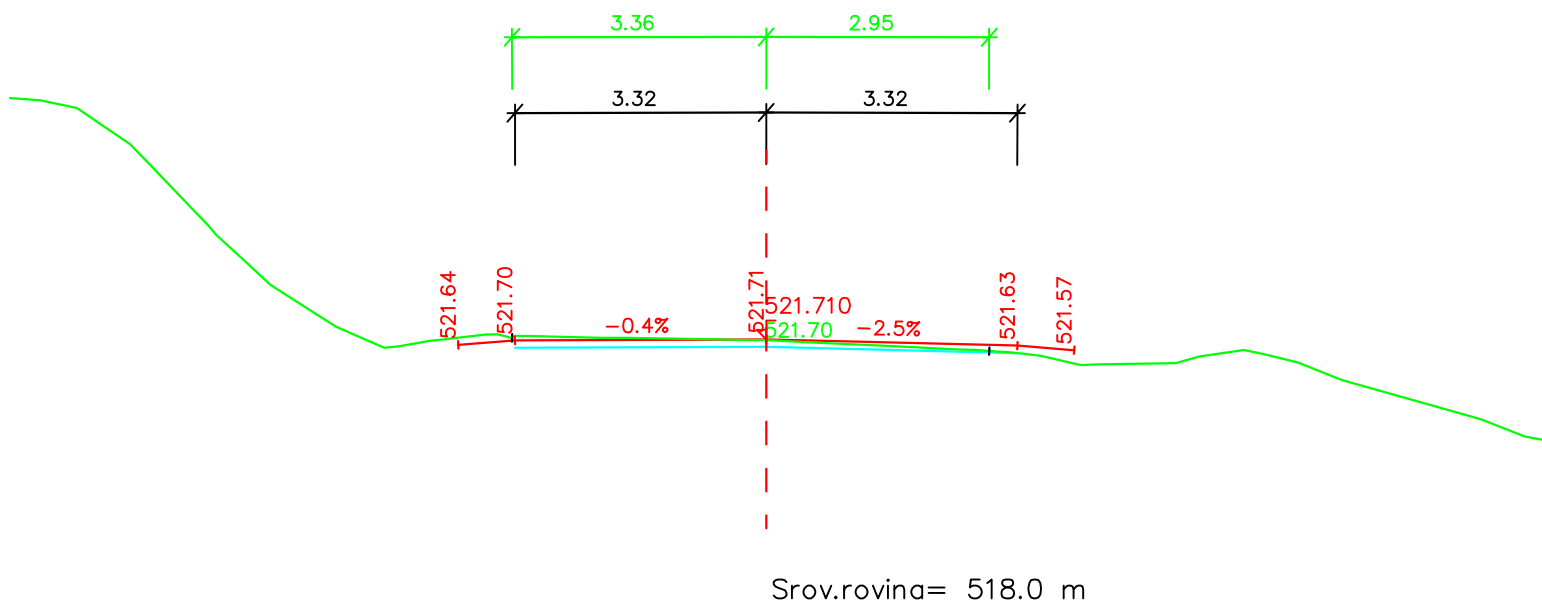

Srov.rovina= 518.0 m

49+000,00

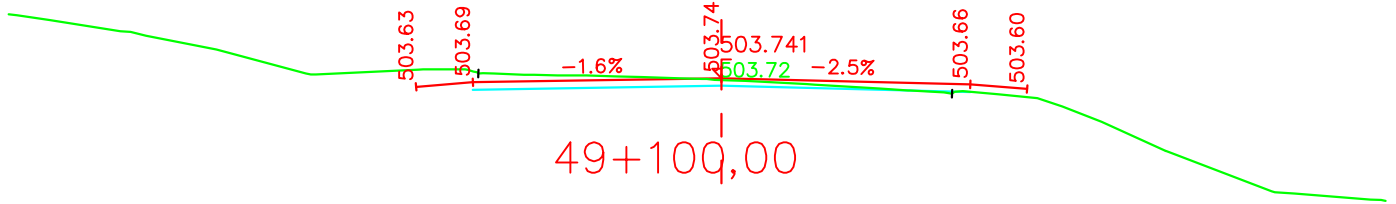
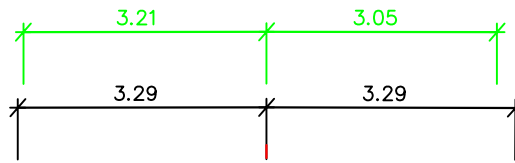

49+100,00

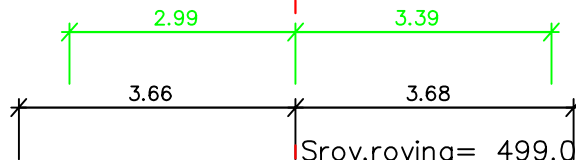

Srov.rovina= 499.0 m

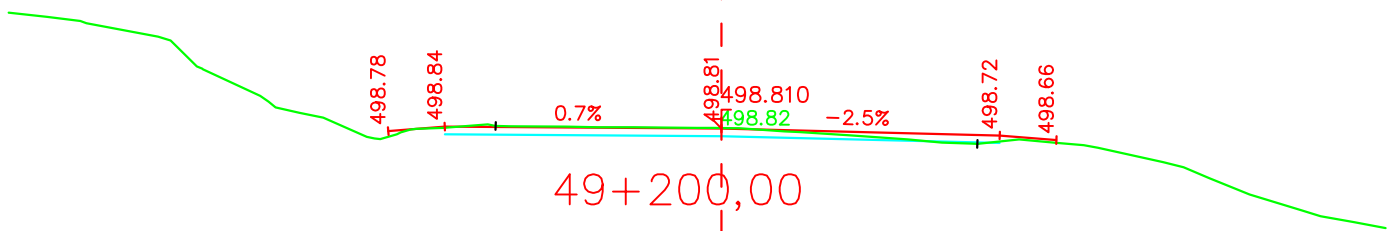

49+200,00

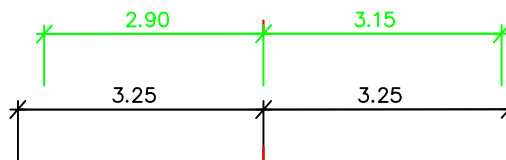

Srov.rovina= 494.0 m

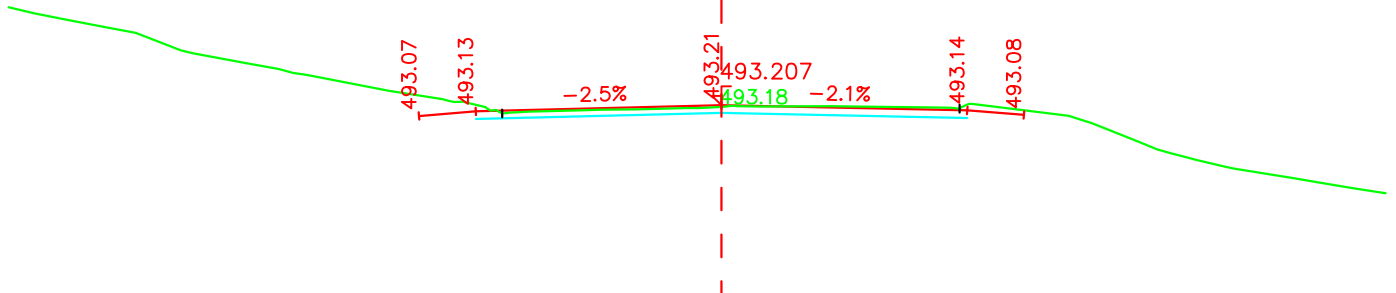

Srov.rovina= 488.0 m

49+700,00

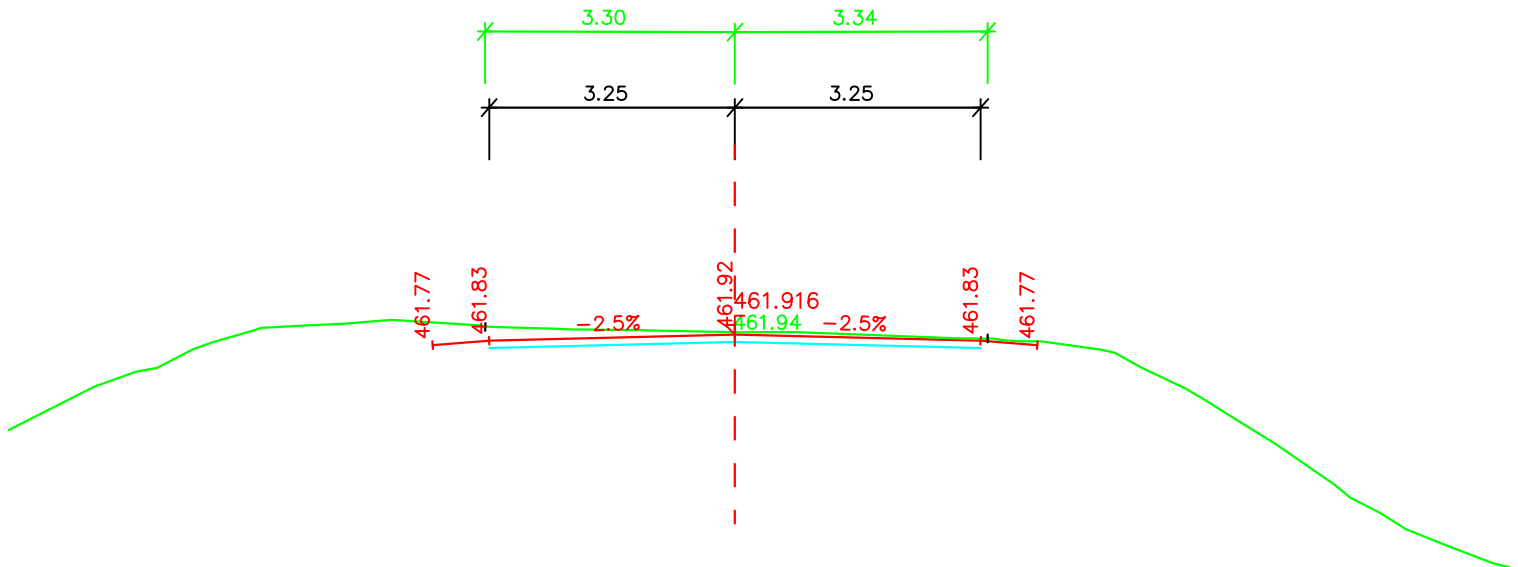

Srov.rovina= 456.0 m

49+800,00

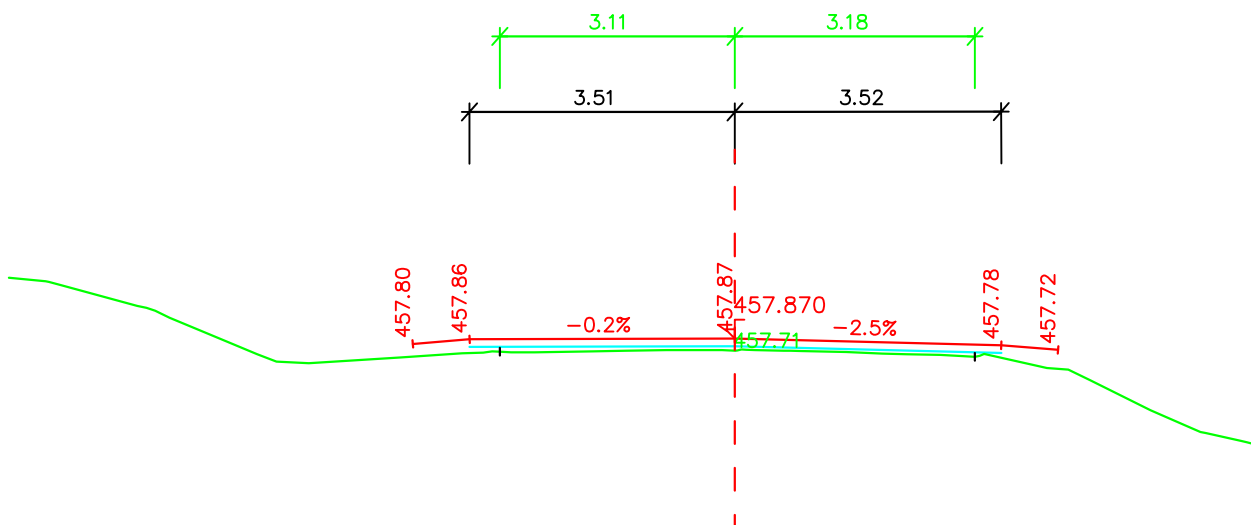

Srov.rovina= 454.0 m

49+900,00

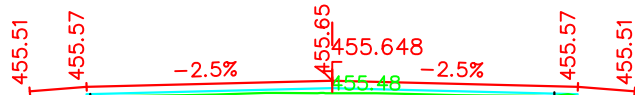
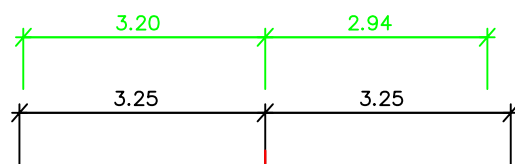

50+000,00

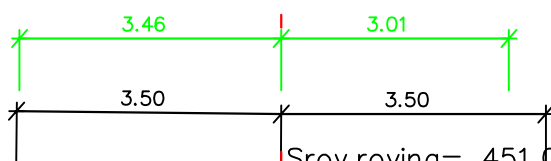

Srov.rovina= 451.0 m

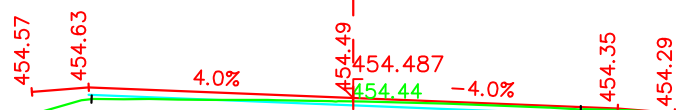

50+100,00

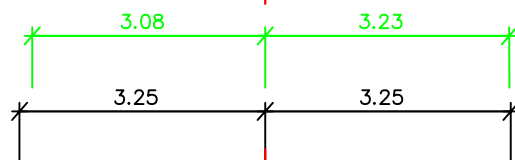

Srov.rovina= 449.0 m

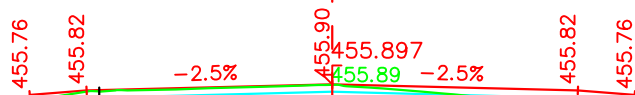

Srov.rovina= 449.0 m

50+200,00

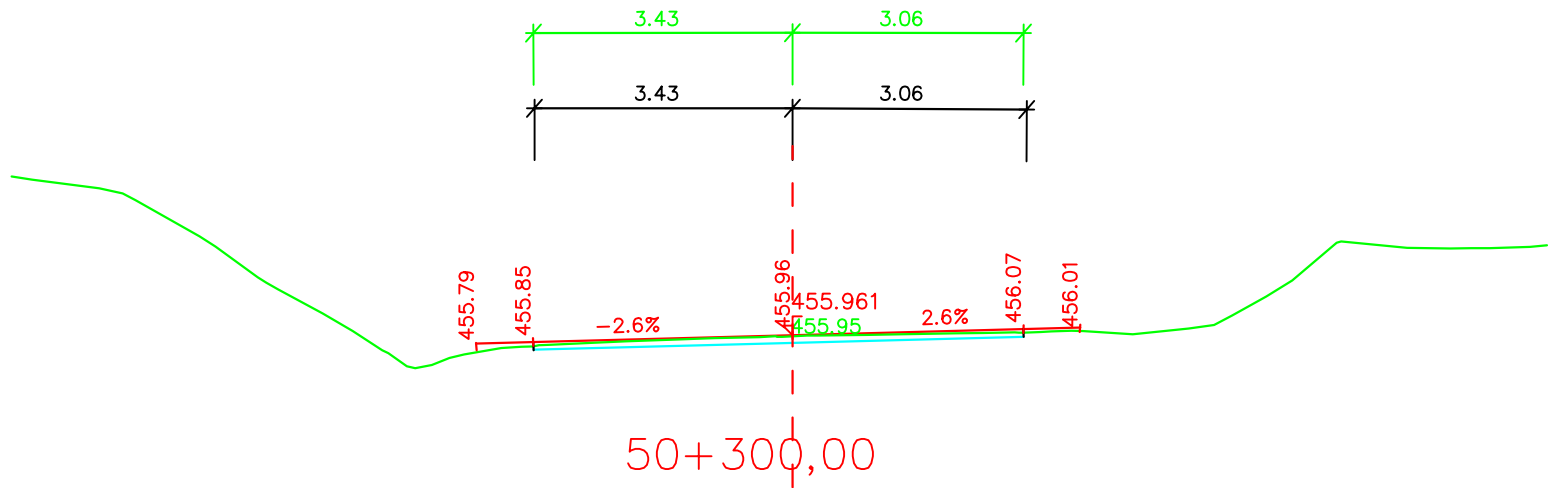

Srov.rovina= 453.0 m

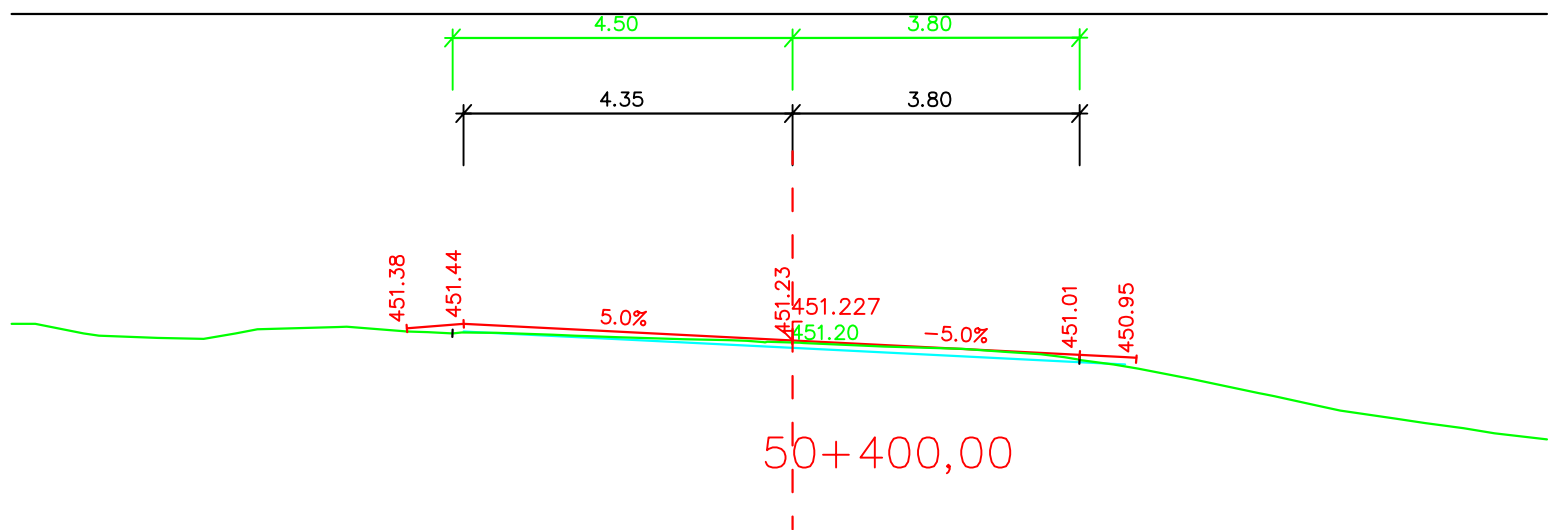

Srov.rovina= 445.0 m

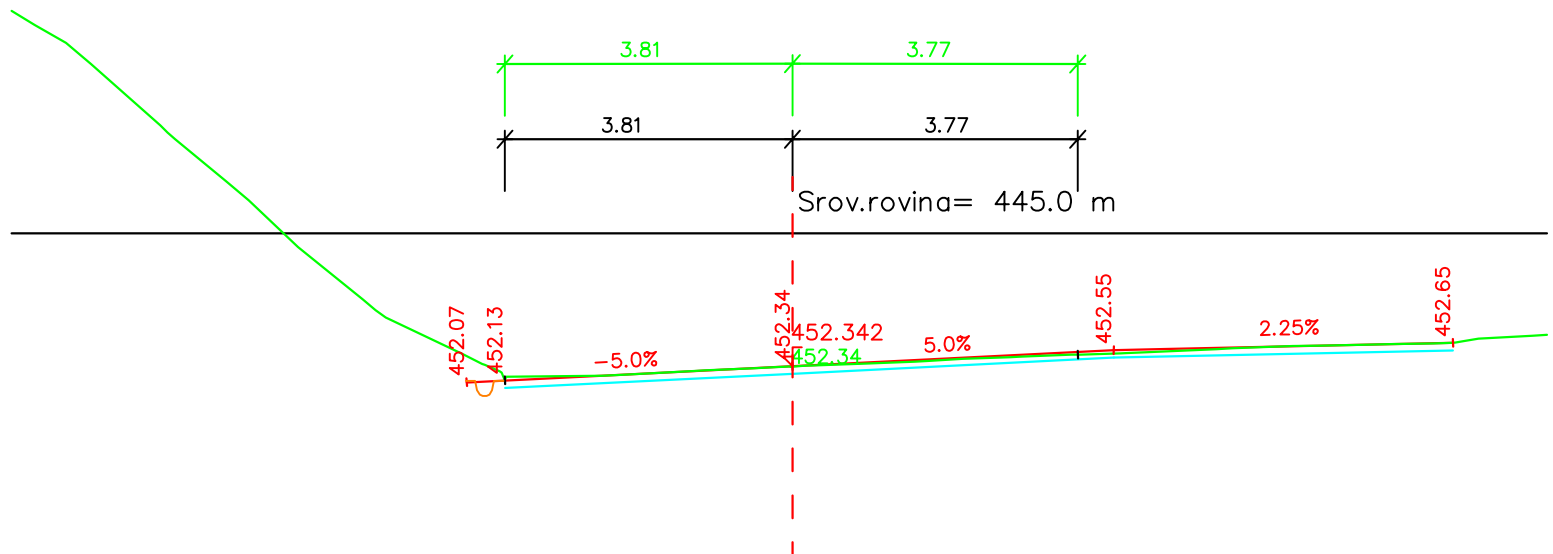

Srov.rovina= 446.0 m

50+500,00

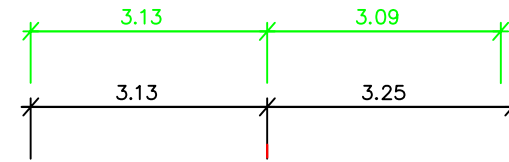

50+600,00

Srov.rovina= 447.0 m

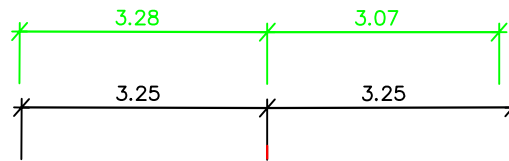

50+700,00

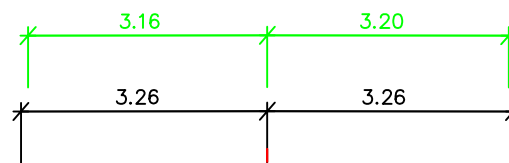

Srov.rovina= 442.0 m

Srov.rovina= 442.0 m

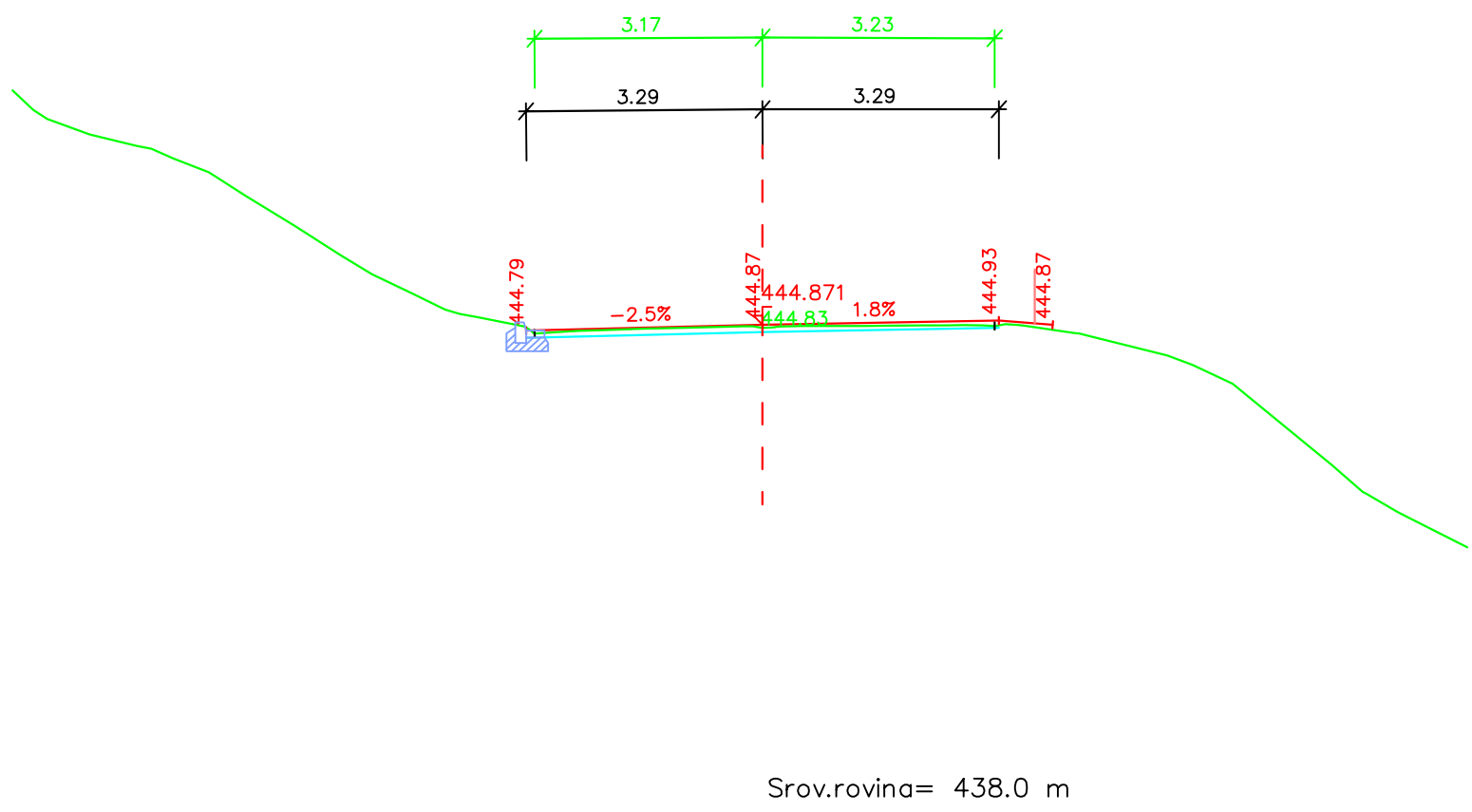
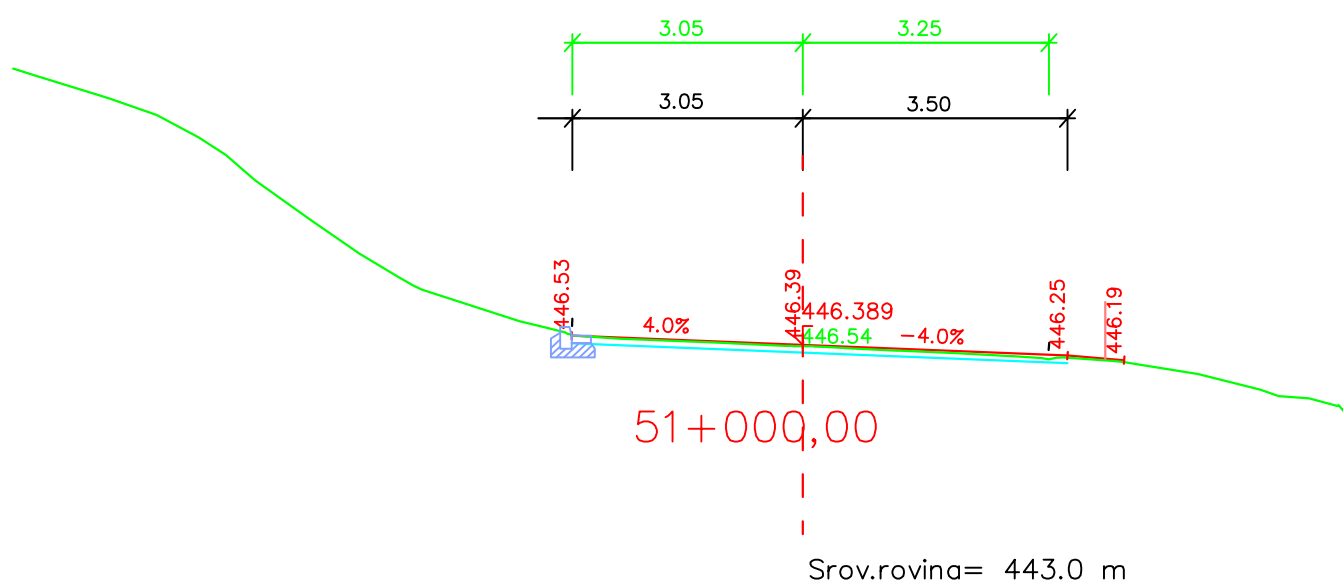
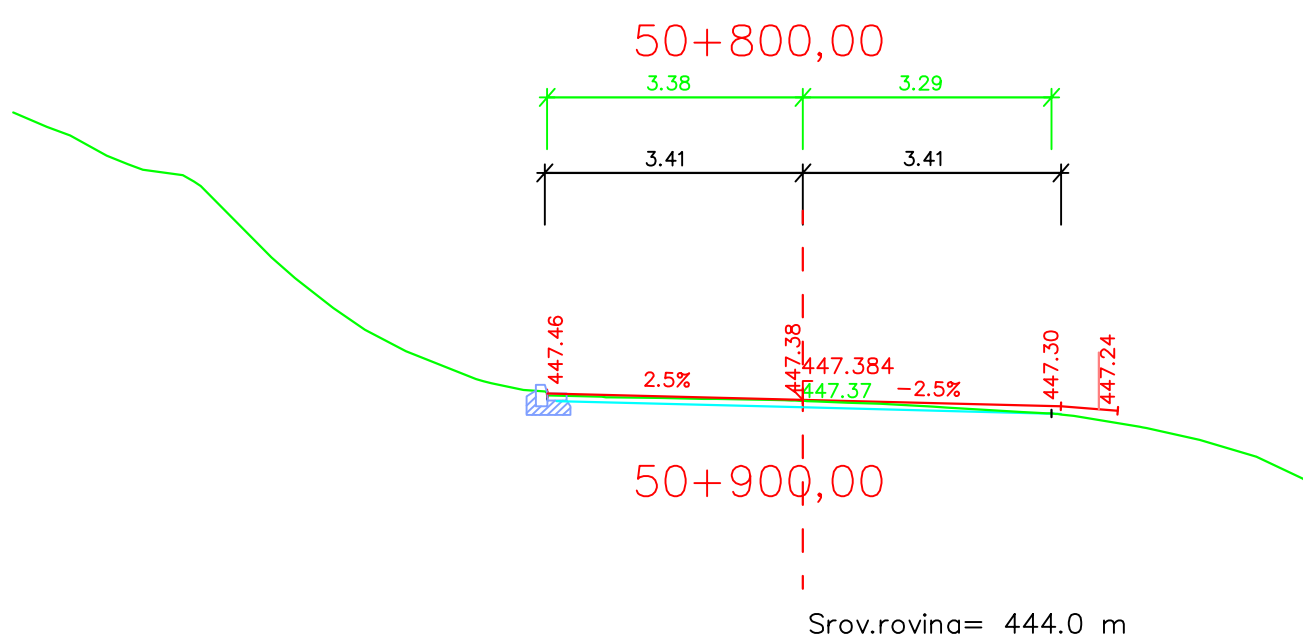

51+100,00

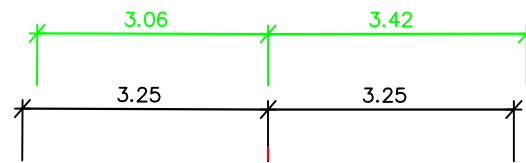

51+200,00

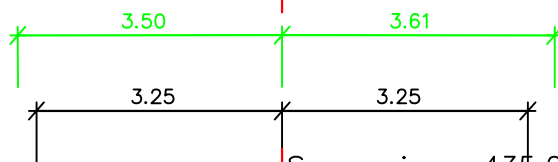

Srov.rovina= 435.0 m

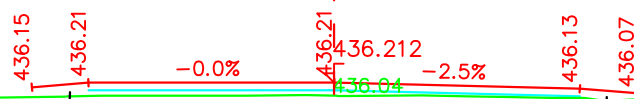

51+300,00

Srov.rovina= 433.0 m

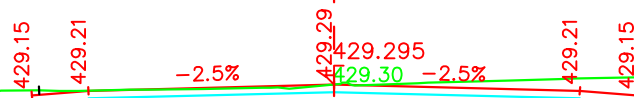
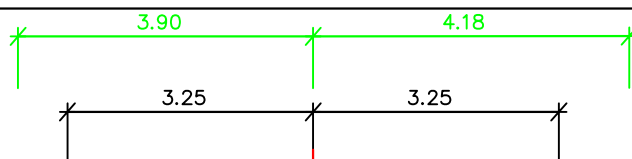

Srov.rovina= 425.0 m

51+400,00

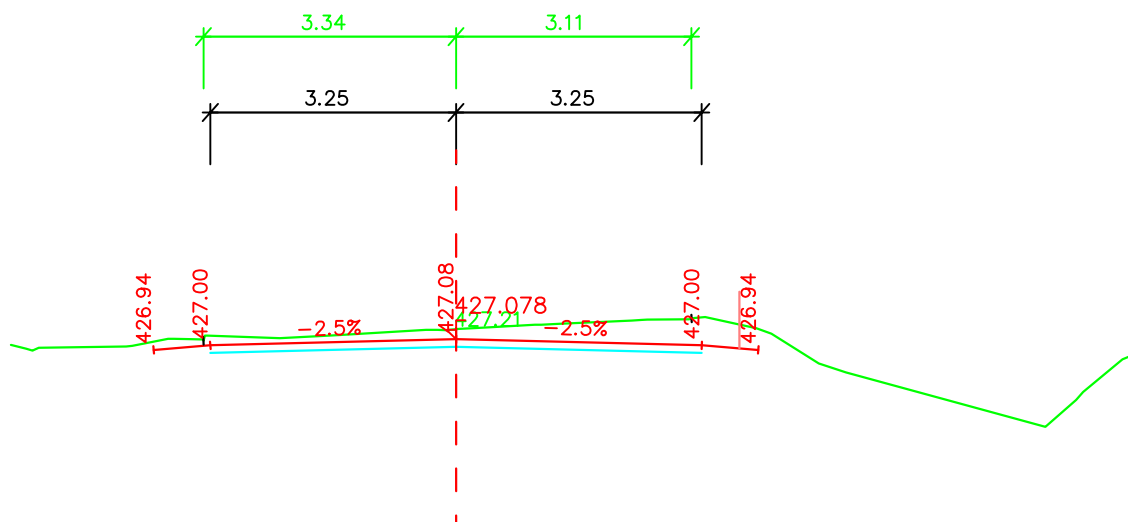

51+500,00

Srov.rovina= 423.0 m

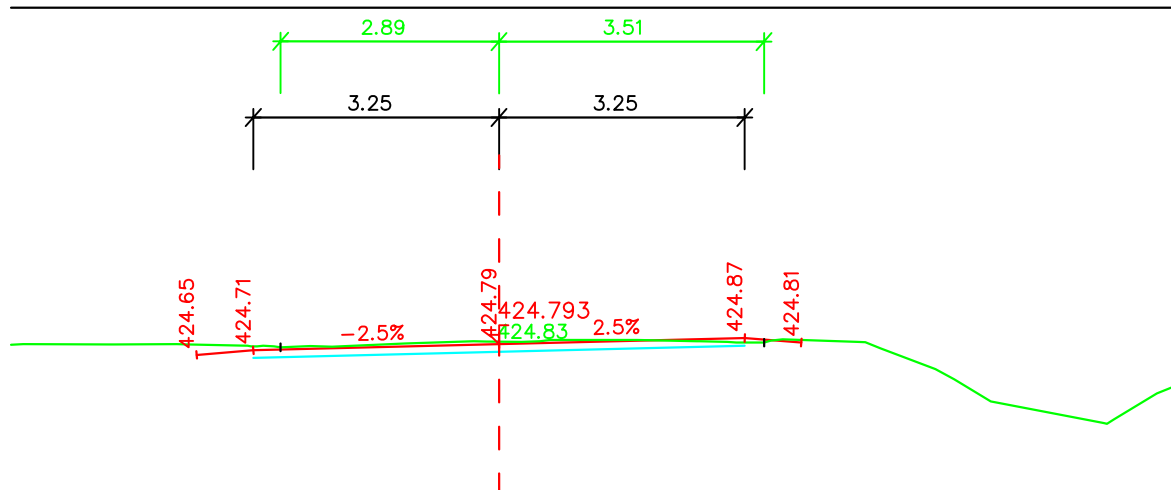

51+600,00

Srov.rovina= 421.0 m

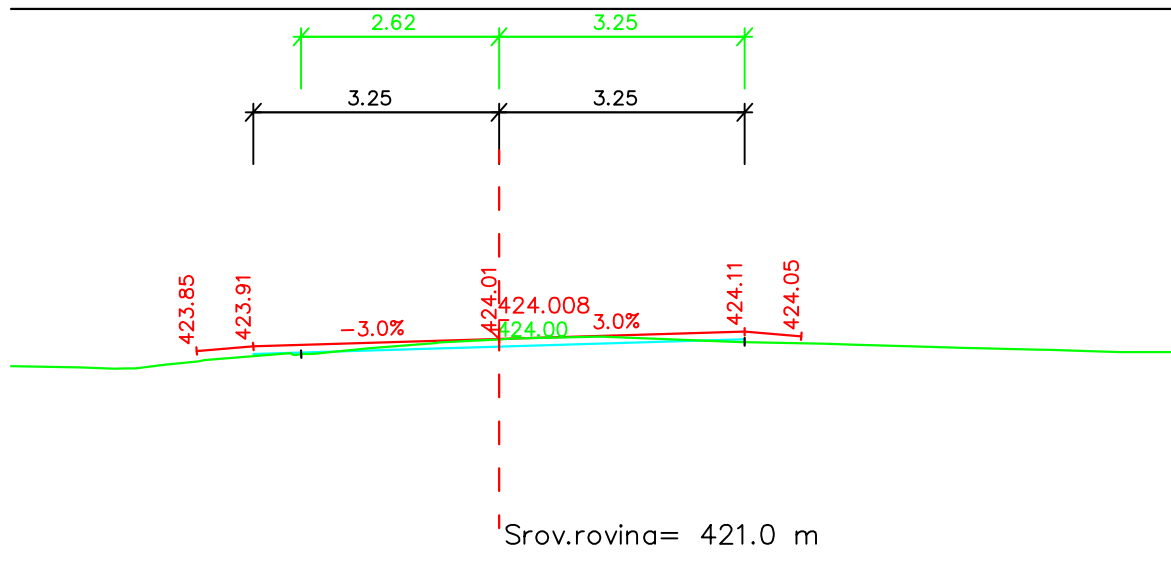

51+700,00

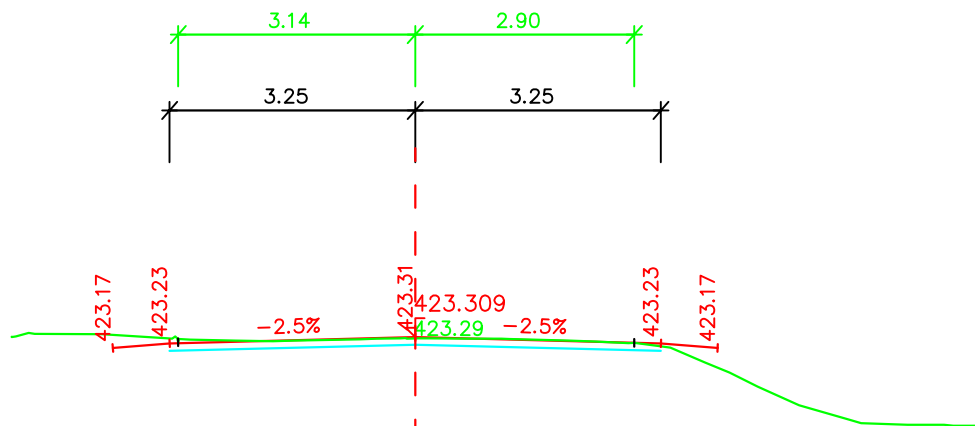

51+800,00

Srov.rovina= 420.0 m

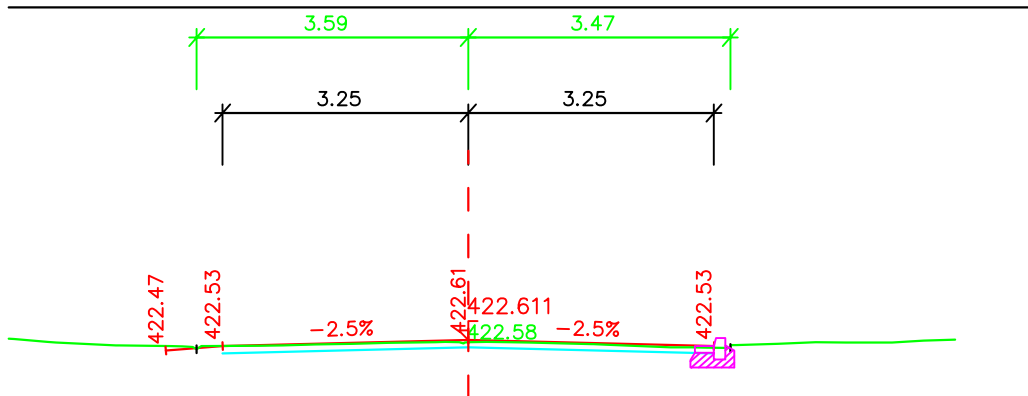

51+900,00

Srov.rovina= 420.0 m

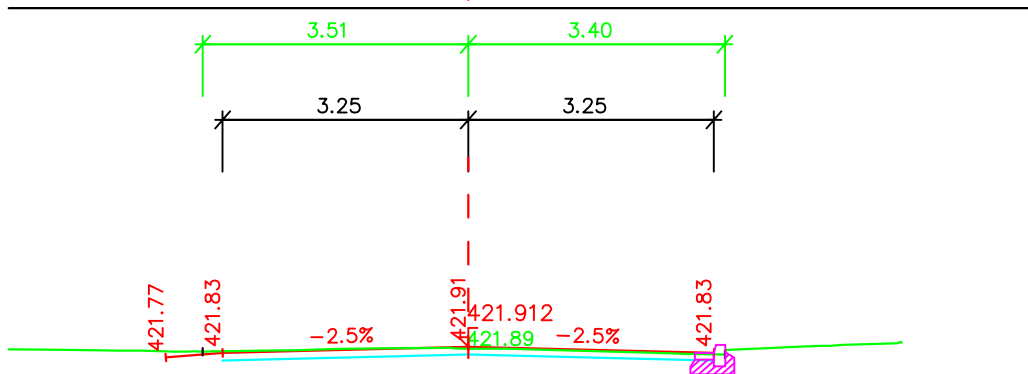

Srov.rovina= 419.0 m

52+000,00

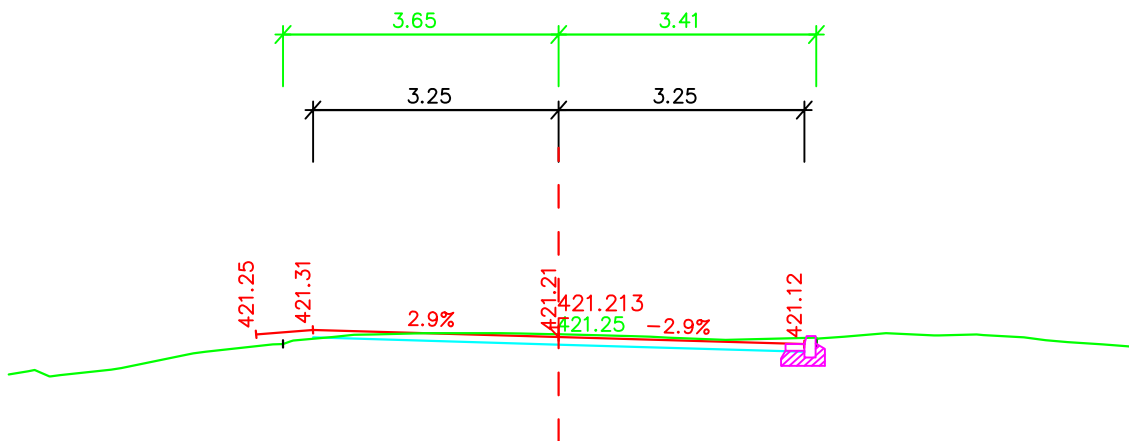

52+100,00

Srov.rovina= 418.0 m

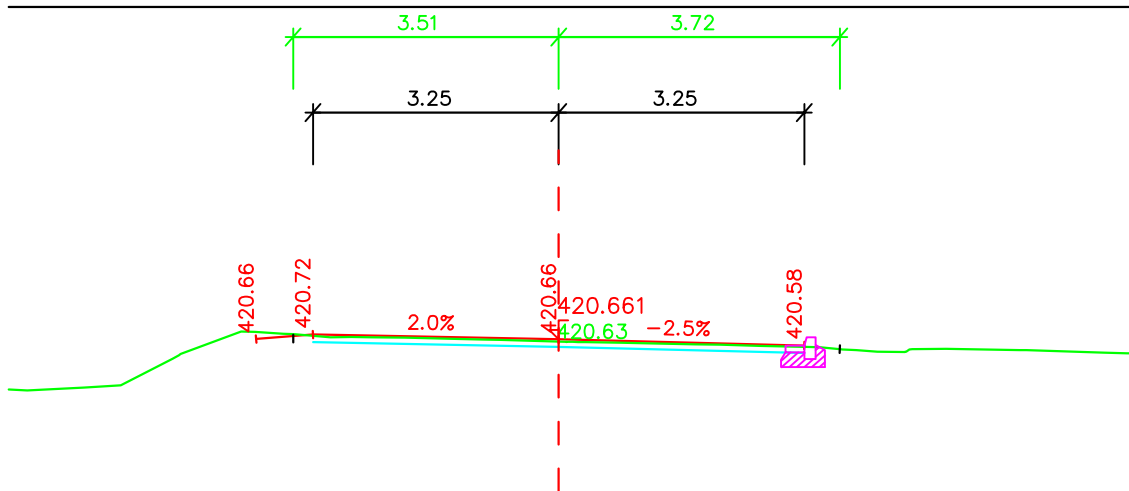

52+200,00

Srov.rovina= 417.0 m

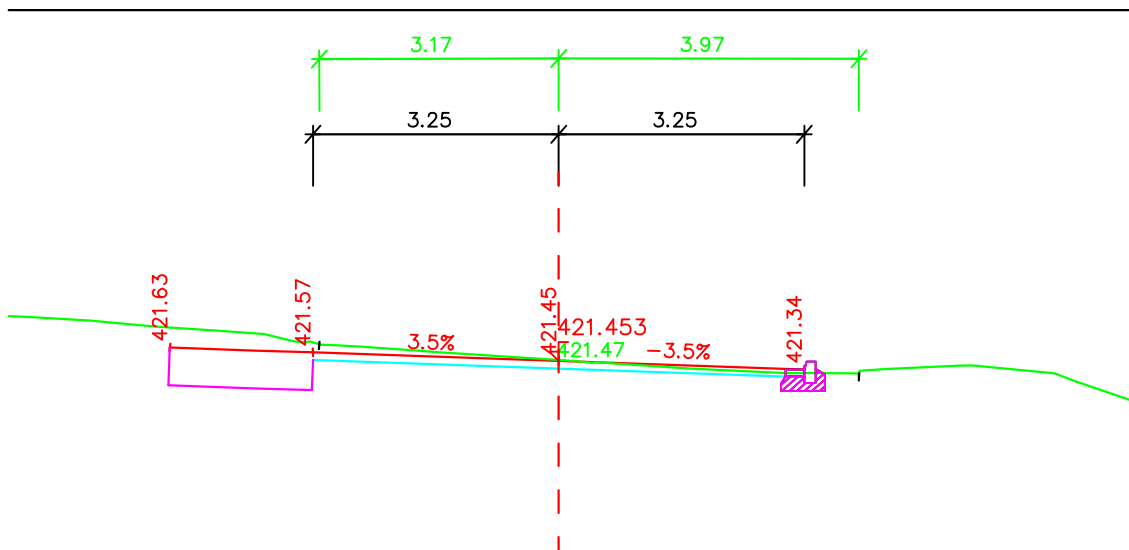

Srov.rovina= 418.0 m

52+300,00

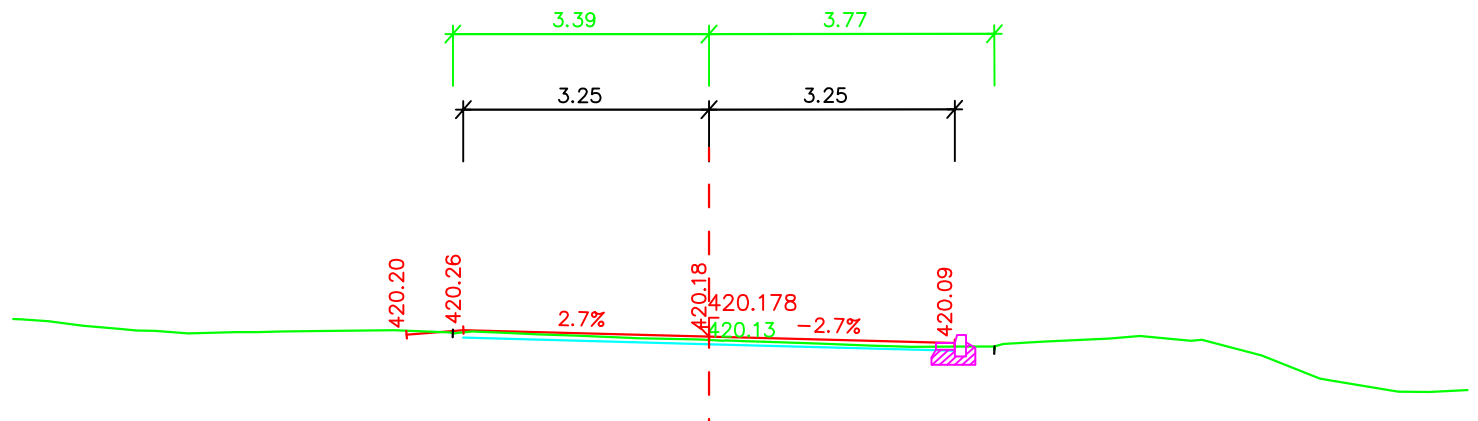

52+400,00

Srov.rovina= 417.0 m

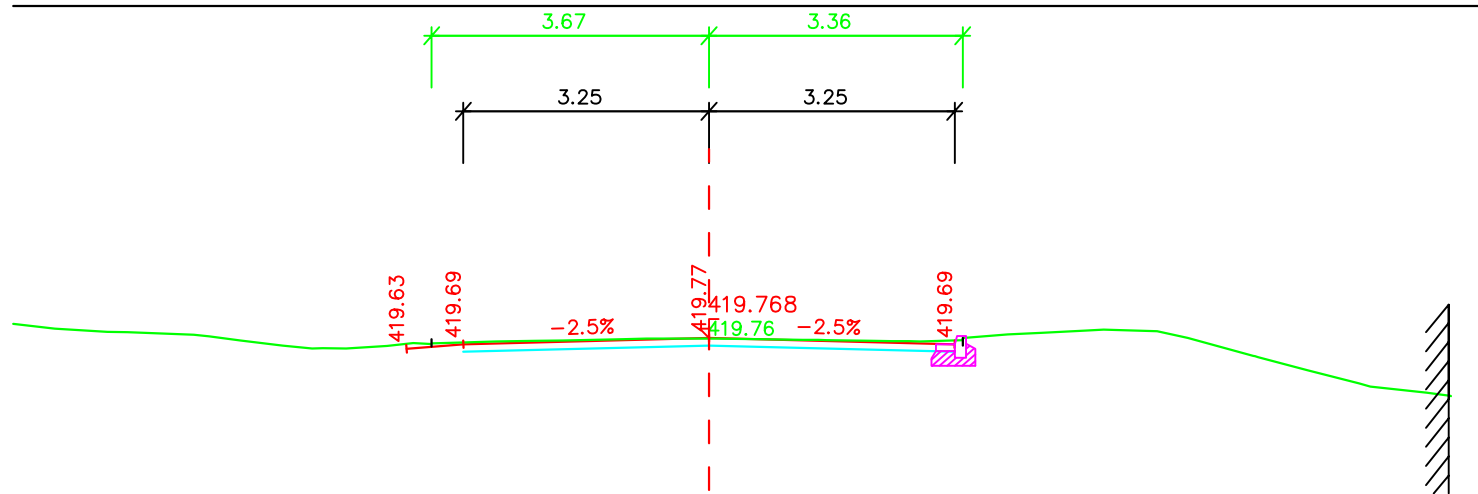

52+500,00

Srov.rovina= 416.0 m

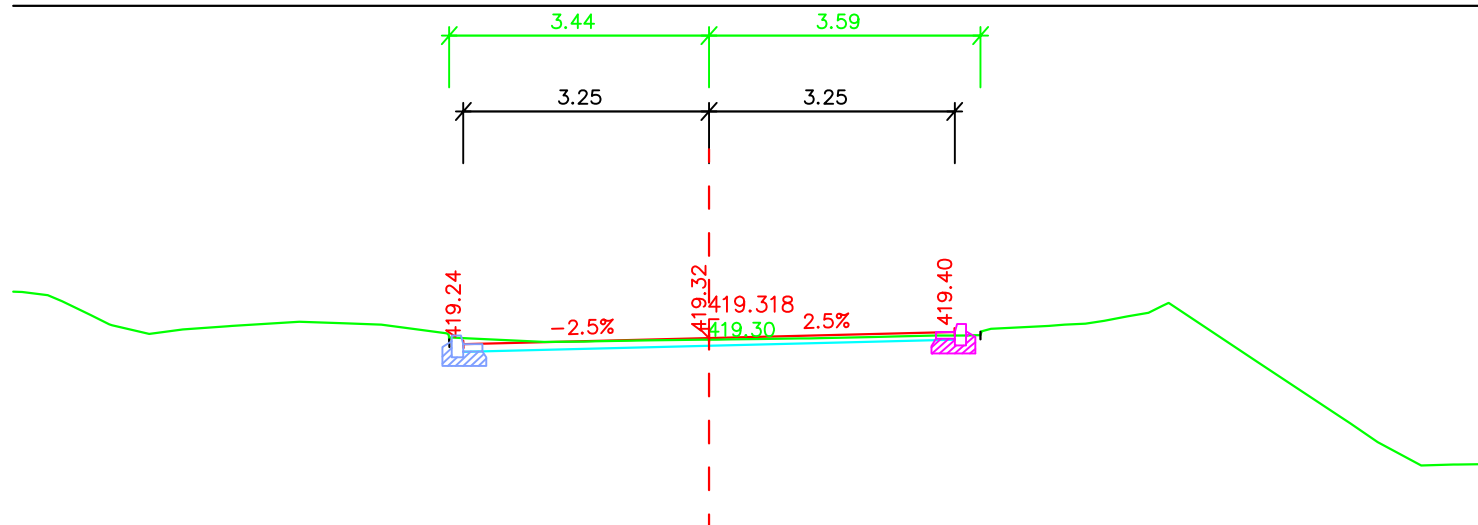

Srov.rovina= 415.0 m

52+600,00

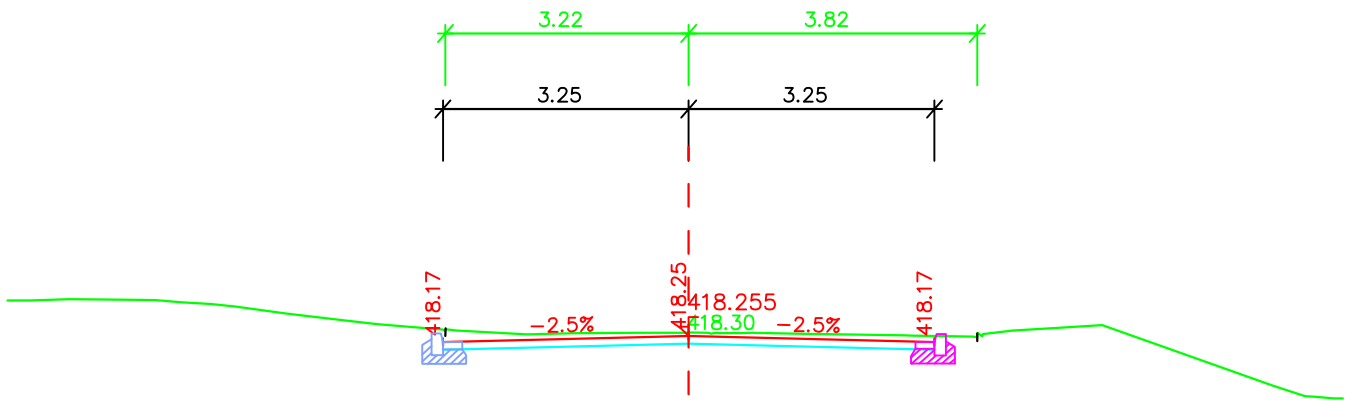

52+700,00

Srov.rovina= 415.0 m

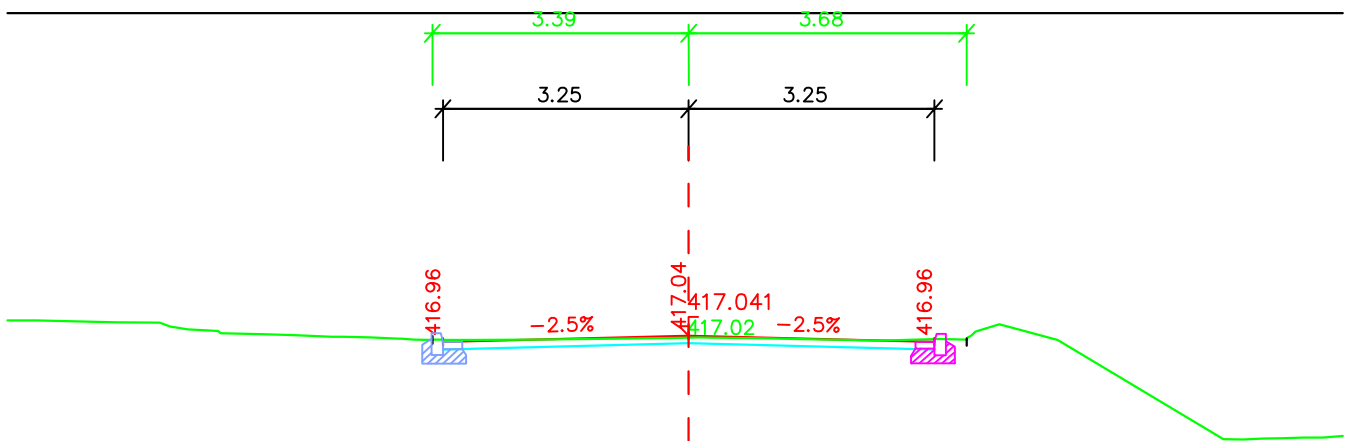

52+800,00

Srov.rovina= 413.0 m

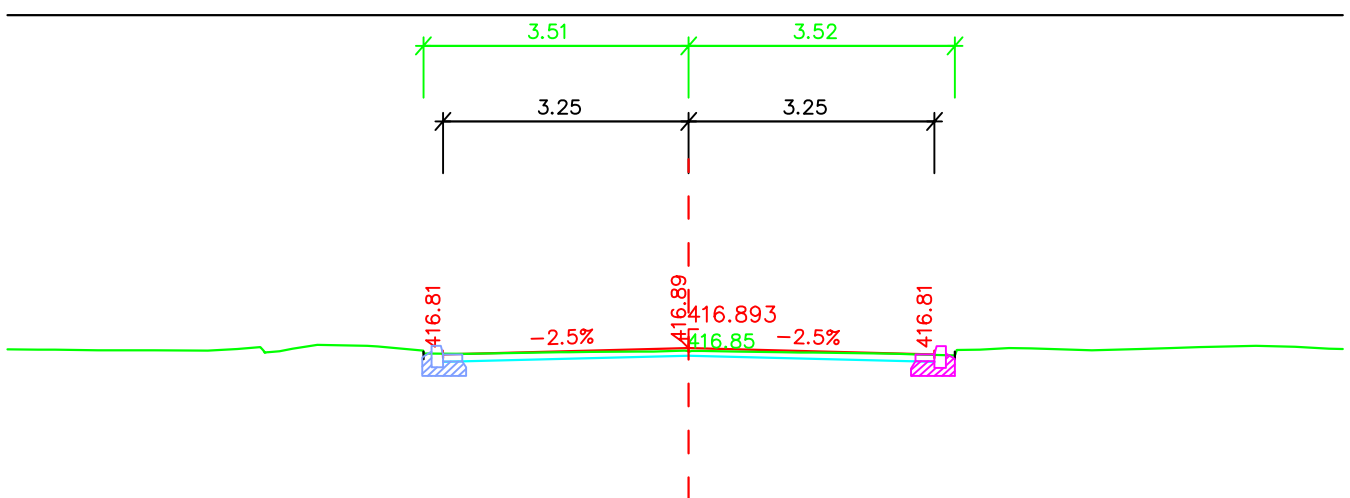

Srov.rovina= 414.0 m